

# Separate Type MARK Sensor

## R series 12 types

For details refer  
this catalogue



R series' MARK Sensor heads detected colored object printed on film, packaging material, chip component, etc. in 200 micro sec.



Amplifier : RSA Connector type  
Cable type

Sensor Head : RT-1500 RS-20R  
RT-F300 RS-16G  
RD-150 RM-16R  
RD-F50 RM-16G

### Dimensions

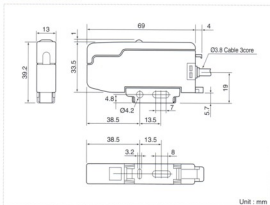

### Typical Characteristics (Examples)

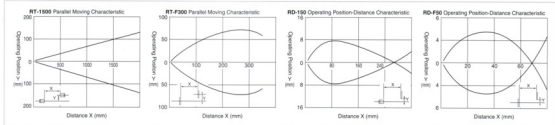

### Specifications

		Amplifier					
Type	Cable type RSA-N / RSA-P			Connector type RSA-CN / RSA-CP			
Supply voltage	10 to 30V DC						
Power consumption	35mA						
Response	Normal mode : 500µs Mark mode : 200µs						
Timer function	OFF delay fixed at 40ms						
Control output	NPN or PNP Open collector output (max 30V DC / 100mA)						
Operation mode	Normal mode / Mark mode						
Circuit protection	Reverse protection, over current protection						
Ambient temp / humidity	-25 to 55 °C / 35 to 85% RH						
Protection category	IP60						
Connection	Cable length 2m			M8 x 4-pin connector			
		Sensor head					
Type	RT-20R (10mm)	RT-150 (16mm)	RT-150G (16mm)	RT-1500 (150mm)	RT-F300 (300mm)	RD-150 (150mm)	RD-F50 (50mm)
Detecting distance	16mm ± 2mm	15mm ± 1mm	15mm ± 1mm	1500mm	300mm	150mm	50mm
Spot size	Ø1mm(20mm)	1 x 4mm(16mm)	Ø1mm(16mm)	1 x 4mm(15mm)	Ø5mm	Ø2.5mm	Ø2.5mm
Standard detecting object	Ø5mm opaque object Ø2.5mm opaque object						
Hysteresis	20%	—	20%	—	—	20%	30%
Light source	Red		Green		Red		
Ambient temp/humidity	-25 to 55 °C / 35 to 85% RH						
Ambient illuminance	Sunlight : 10000 lux, Halogen : 3000 lux						
Protection category	IP66			IP50		IP66	IP50
Shock resistance	50G (X-Y-Z 3 times each)						
Vibration resistance	10 to 50Hz (Multiple amplitude 1.5mm X-Y-Z 2 hours each)						

● Specifications are subject to change without prior notice for improvement.